

FITTING INSTRUCTIONS

RP17 - Door Bottom Sweep Seal



HOW TO FIT RP17

Note: For easy door operation, determine which side of the door the RP17 will function best. Flexible seal should lightly engage the sealing surface and sweep smoothly across the floor. Uneven or ramped floors may cause the seal to drag. Recommended adhesion temperature is above 21°C. Allow a few days for full adhesion strength to occur.

- Seal can be fitted to the inside or outside of the door. Surface must be clean, smooth and if painted, well cured. *Note: Self-adhesive seals will not stick to oil-rub finishes.*

FIG.A (section view)

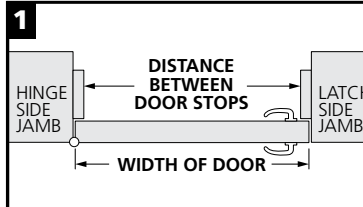
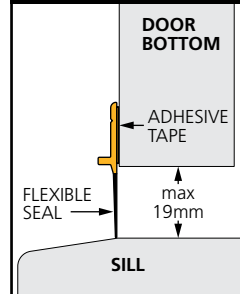

- Measure the side of the door you wish to fit the seal, either between the stops or the full width of the door.

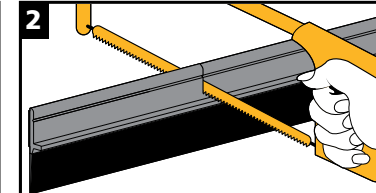

- With a fine toothed hacksaw, cut seal to the required length.

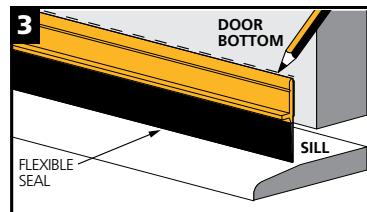

- Before removing adhesive backing paper, with door closed, place seal against door bottom and mark fixing position. Flexible seal should lightly touch the sill surface.

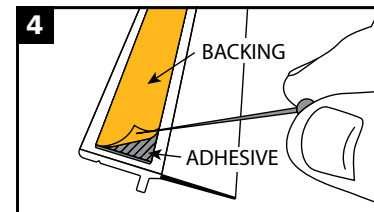

- Use a pin to carefully separate backing from adhesive.

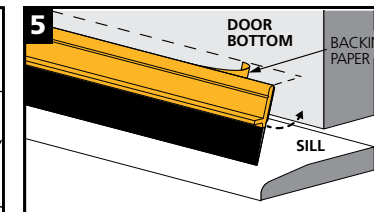

- Very carefully position seal on the marked line.
- When satisfied, firmly press seal to door surface.